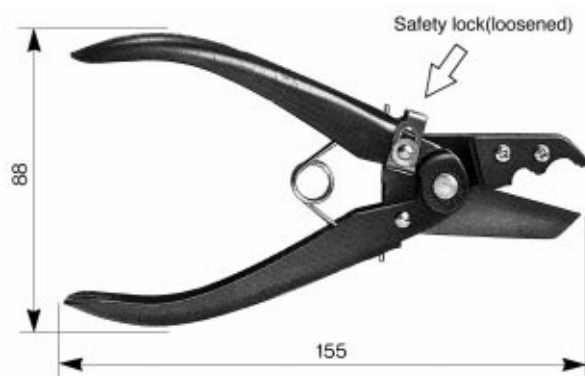

Tube Cutter

Series TK**Tube Cutter: TK-1****Perpendicular cutting****Reduced operating force****Enclosure/safety lock contained**

Note) Never cut metals such as electric wires.

Part No.	TK-1
Tube material	Nylon, soft nylon, polyurethane, and other soft plastic tube
Tube O.D.	13mm or less
Weight	140g

Tube Cutter: TK-2**Possible to cut a tube up to 18mm.**

Note) Never cut metals such as electric wires.

Part No.	TK-2
Tube material	Nylon, soft nylon, polyurethane, and other soft plastic tube
Tube O.D.	18mm or less
Weight	140g

K ☐M ☐H ☐D ☐MS ☐T ☐

Series TK

Tube Cutter: TK-3 (Useful type)
Safety lock contained.

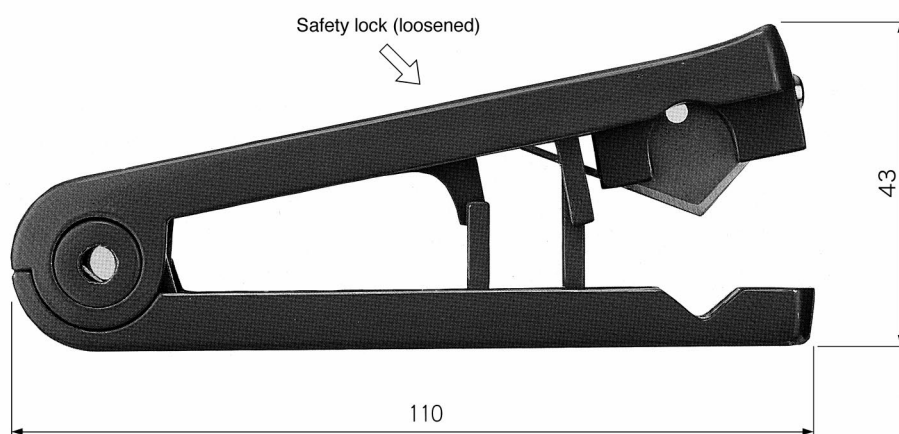

Note) Never cut metals such as electric wires.

Part No.	TK-3
Tube material	Nylon, soft nylon, polyurethane, and other soft plastic tube
Tube O.D.	12mm or less
Weight	32g

Accessories/Tools

Tube Releasing Tool

Series TG

- For loading and unloading of tubes for One-touch fittings mounted in a narrow space or on manifolds.
- Easy one-hand operation
- Available for two sizes of applicable tubes. Easy exchange with one hand.

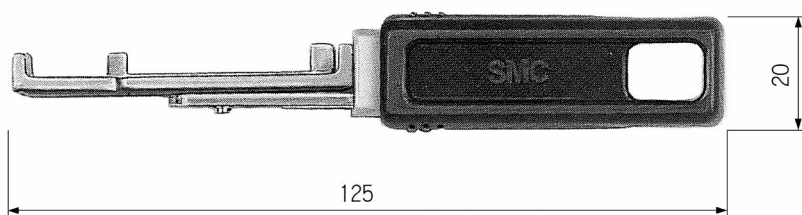

Part No.	Tube size		Tube material	Color	Weight
TG-1	Metric size	ø4, ø6	Nylon, Soft nylon, Polyurethane	Blue	33g
TG-2	Inch size	ø 1/8", ø 1/4"		Red	

How to Use

⚠ Caution

Process

- ① Put the end of tool into the release button parallel to the tube.

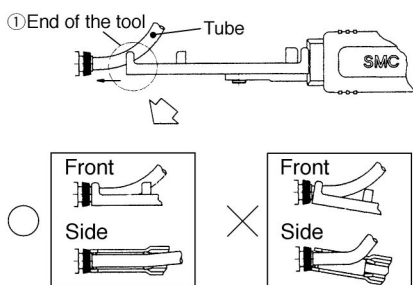

- ② After inserting, grasp the handle tightly and insert the end of the tubing to the stroke end.

[Note) Insert firmly to guard against accidental tube release.]

- ③ After inserting end of tube, relax your grip on the tool. Returning force of spring releases the tube.

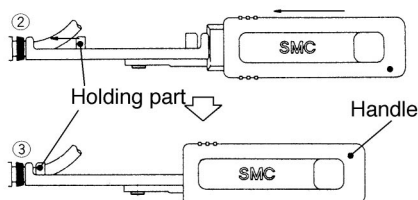

Size change

Push both sides at once to release. Reverse and fix at the same position as before. Applicable tube size is indicated on the back side.

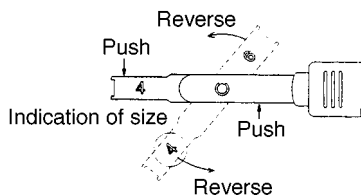

K ☐

M ☐

H ☐

D ☐

MS ☐

T ☐