

Rotary Clamp Cylinder/Double Guide Type

Series MK2T

ø20, ø25, ø32
ø40, ø50, ø63



Construction

MK2T□20 to 63

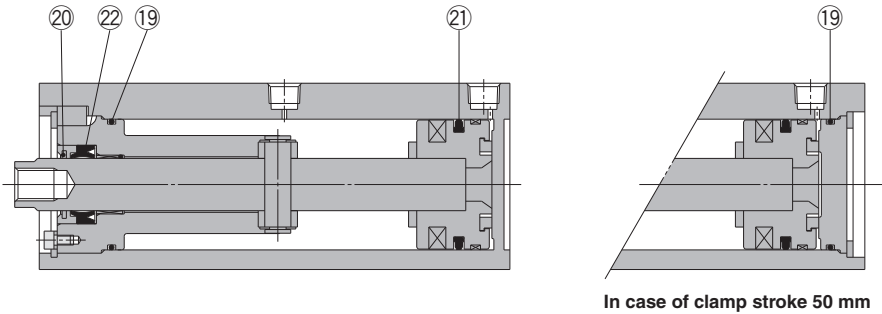

* The numbers are the same as the "Construction" of the Best Pneumatics No.3 Series MK2T.

Seal Kit List

| No. | Description | Material | Note |
|-----|--------------|----------|------|
| 19 | Gasket | NBR | |
| 20 | Coil scraper | Bronze | |
| 21 | Piston seal | NBR | |
| 22 | Rod seal | NBR | |

Replacement Parts: Seal Kit

| Bore size (mm) | Kit no. | Content |
|----------------|-----------|---------------------------------|
| 20 | MK2T20-PS | Set of left nos. 19, 20, 21, 22 |
| 25 | MK2T25-PS | |
| 32 | MK2T32-PS | |
| 40 | MK2T40-PS | |
| 50 | MK2T50-PS | |
| 63 | MK2T63-PS | |

* Seal kit includes 19, 20, 21, 22. Order the seal kit, based on each bore size.